

PCB BOARD LAYOUT

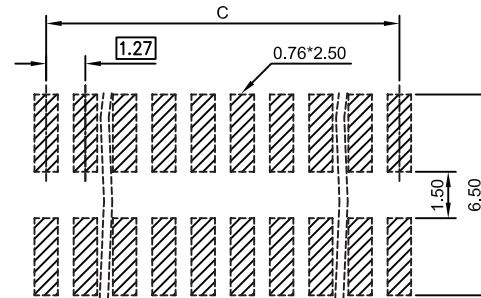

Specifications

- Current Rating: 1A
- Insulation Resistance: 1000M ohms / min
- Contact Resistance: 20m ohms max.
- Withstand Voltage: 300V AC
- Temperature Range: LCP : -55°C ~ +125°C (Standard)
Nylon-6T: -40°C ~ +125°C
- Contact Material: Brass
- Insulator Material: Polyester, UL94V-0 LCP (Standard)
Polyester, UL94V-0 Nylon-6T
- Contact Plated: See options
Standard: Full Gold Flash

Part Numbering System

BH7C-SD-545155 - XX - X L

- Series
- No. of Pins
- Contact Plating
- Insulator Material:
L = LCP (Standard)
N = High Temperature Nylon-6T

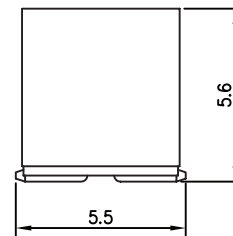
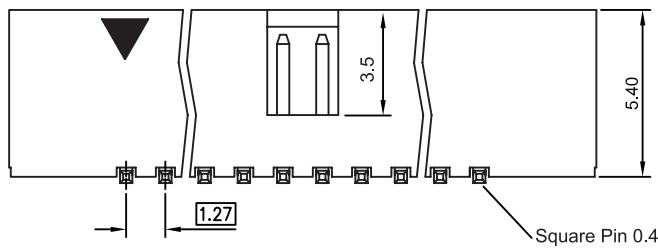

Contacts	Dimension mm			Contacts	Dimension mm		
	A	B	C		A	B	C
06	10.11	8.56	2.54	34	27.89	26.34	20.32
10	12.65	11.10	5.08	40	31.70	30.15	24.13
12	13.92	12.37	6.35	44	34.24	32.69	26.67
14	15.19	13.64	7.62	50	38.05	36.50	30.48
16	16.46	14.91	8.89	60	44.40	42.85	36.83
20	19.00	17.45	11.43	64	46.94	45.39	39.37
24	21.54	19.99	13.97	68	49.48	47.93	41.91
26	22.81	21.26	15.24	80	57.10	55.55	49.53
28	24.08	22.53	16.51	100	69.80	68.25	62.23
30	25.35	23.80	17.78				

* Contact Plating Option	Full Gold Plating	Gold Plated On Contact Area Tin Plated on Solder Area	Full Tin Plating
	G : Gold Flash G10: Gold 10u" G15: Gold 15u" G30: Gold 30u"	S: Gold Flash S10: Gold 10u" S15: Gold 15u" S30: Gold 30u"	T: Tin 100u"

General Tolerance	
X. ± 0.50	X.° ± 5°
.X ± 0.20	.X" ± 2°
.XX ± 0.10	.XX" ± 1°
Units : mm	